

AP MORGAN



Newman Way, Rednal, Birmingham
Asking Price £120,000

Features:

- Convenient sized ground floor maisonette
- One double bedroom and separate study/storage space
- Good sized lounge/diner
- Kitchen
- Bathroom with bath and electric shower
- Front garden
- Resident parking
- EPC- TBC

Description:

Selling with tenants in situ This convenient sized, one bedroom ground floor maisonette is situated in the popular area of Rednal, Birmingham and is ideal for first time buyers or those looking to downsize.

Approaching the property there is a small, low maintenance front garden with fencing along each border and a pathway leading to the entrance porch. There is resident parking a short walk away from the property.

Moving inside, the property briefly comprises of an entrance porch; good sized lounge; kitchen with space for freestanding appliances; one double bedroom; study/storage cupboard with space for a small desk and chair and finally a bathroom with bath and electric shower. This property is well situated for easy access to Rubery Village for local shops and amenities. Nearby Great Park provides additional shops, bars, restaurants, and entertainment, with a bowling alley and cinema. Longbridge and Northfield town centres provide additional shops and amenities within driving distance. The property is also conveniently positioned for travel via road to Birmingham city centre, the M5 and M42 motorways, and beyond.

Details:

Lounge/Diner 12'10" x 9'5" (3.9m x 2.87m)

Kitchen 9'10" x 5'3" (3m x 1.6m)

Bedroom 11'6" x 7'7" (3.5m x 2.3m)

Storage/Study 7'6" x 6'6" (2.29m x 1.98m)



Bathroom 5'9" x 5'5" (1.75m x 1.65m)

Porch

EPC Rating: To be confirmed

Council Tax Band: A (tbc by solicitors).

Tenure: Leasehold (tbc by solicitors).

For more information or to arrange a viewing, please call us on 0121 827 6827.



How can we help you?

Need a mortgage?

We recommend Wiser Mortgage Advice. They will search the market for you to ensure you get the right lender and mortgage deal. They typically achieve mortgage offers much more quickly than if you were dealing with lenders directly. The initial appointment is free and without obligation. Call us on 0121 827 6827, or visit their website for more information: www.wisermortgageadvice.co.uk

Property to sell?

If you need to sell a property in order to buy, you ideally need to be on the market at least (and preferably Sold STC) before viewing, otherwise you may lose out to other buyers when the right property comes along. In these circumstances we can get your property 'live' quickly. Just book a free valuation and we will visit your property and discuss your needs.

Need a solicitor?

A good solicitor can save you literally weeks of time in the buying/selling process, reducing the stress levels of all involved. We will instruct a reputable firm that is competitive on cost and very reliable. Just ask for a quote.

Need a removal company and storage?

A professional removal company takes the stress out of moving. Knowing that your belongings are safe and insured far outweighs any small savings by trying to do it yourself or using a man-and-a-van service. We work closely with and recommend Cube Removals as the leading local firm. For peace of mind and a reliable service call them on 0800 193 0000 or visit their website, cuberemovals.co.uk, to arrange a survey.

GROUND FLOOR (40.0 sq.m.) approx.

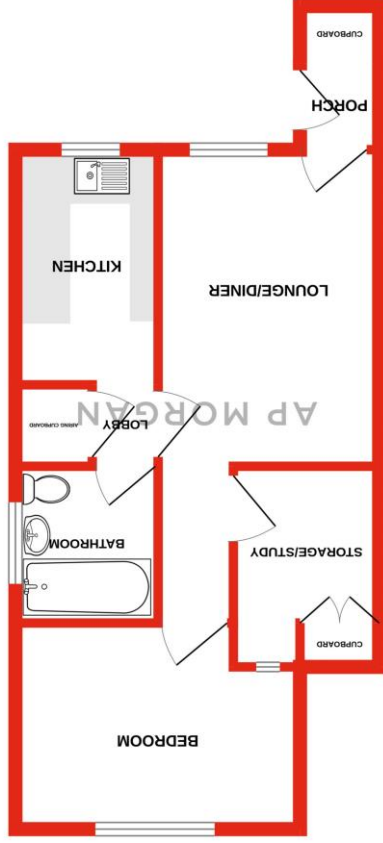

108A NEWMAN WAY
TOTAL FLOOR AREA: 430 sq.ft. (40.0 sq.m.) approx.
Whilst every attempt has been made to ensure the accuracy of the floorplan contained here, measurements of rooms, windows, doors and any other items are approximate and no responsibility is taken for any error, omission or mis-statement. This plan is for illustrative purposes only and should be read as such by any prospective purchaser. The services, systems and appliances shown have not been tested and no guarantee as to their operability or efficiency can be given.
Made with Metropix ©2024

No statement in these details is to be relied upon as representation of fact, and purchasers should satisfy themselves by inspection or otherwise as to the accuracy of the statements contained within. These details do not constitute any part of any offer or contract. AP Morgan and their employees and agents do not have any authority to give any warranty or representation whatsoever in respect of this property. These details and all statements herein are provided without any responsibility on the part of AP Morgan or the vendors. Equipment: AP Morgan has not tested the equipment or central heating system mentioned in these particulars and the purchasers are advised to satisfy themselves as to the working order and condition. Measurements: Great care is taken when measuring, but measurements should not be relied upon for ordering carpets, equipment, etc. The Law of Copyright protect this material. AP Morgan is the Owner of the copyright. This property sheet forms part of our database and is protected by the database right and copyright laws. No unauthorised copying or distribution without permission.